



**DIY**  
Conservatory  
Quotes

Your new conservatory is just around the corner...

# Contents

## Conservatory Styles

Edwardian	pg 4
Victorian	pg 5
Traditional Lean-to	pg 5
Gullwing	pg 6
Gable End	pg 6
Orangery	pg 7
Bespoke	pg 8
Box Gutters	pg 8

## The Building Process

Konnect Technology	pg 10
Measuring for your Conservatory	pg 11
Durabase	pg 12
Panel Styles	pg 13
Glazing Options	pg 14
Glass Roofs	pg 15
Decorative Glazing Bevels	pg 16
Bifolding & Patio Doors	pg 17
Your Choice of Frame Colours	pg 17

## Other Products Available

Stratus Lantern Roof	pg 18
WarmCore Bifold Doors	pg 19
WarmCore Patio Doors	pg 19
WarmCore Windows	pg 20
Celsius Solid Roofs	pg 21

## Frequently Asked Questions

pg 22

**We're one of the UK leaders in supplying PVCu DIY conservatories, and can now offer you a matchless choice of the best looking, best made, easy to fit conservatories, all priced at around 60% less than you are likely to be quoted by supply and fit conservatory companies.**

- We offer a stunning range of designs, including a free bespoke design service to suit every home
- We provide you with clear, easy to use plans to make installation a simple and smooth process
- Our delivery promise ensures your conservatory arrives at a time to suit you
- We provide a full 10-year guarantee on every conservatory, for total peace of mind



Unit L Linwood Workshops  
Linwood Lane  
Leicester LE2 6RL  
0116 2960728  
[www.diyconservatoryquotes.co.uk](http://www.diyconservatoryquotes.co.uk)  
[www.conservatorybasecompany.co.uk](http://www.conservatorybasecompany.co.uk)



# Edwardian

The Edwardian conservatory is a popular style due to its streamlined elegant structure and the ease of fitting furniture into its rectangular shape.

This simple structure means the Edwardian conservatory lends itself well to small spaces; its rectangular base maximising the floor space available in even the smallest garden. The design also offers extra headroom, giving a spacious feel to every conservatory.

Edwardian conservatories are available with a standard roof as well as a double-hipped roof for bungalows. This allows for increased roof height, regardless of the height of the building it is connected to.

So whether your house is as tall as a mansion or is a single level bungalow, the Edwardian is a great choice for any home.



A square fronted, duo-pitch roof with a central ridge that optimises floor space.



Double-hipped conservatories are great for smaller buildings.



## Edwardian Double-Hipped

Edwardian double-hipped conservatories are a perfect choice for bungalows and cottages. While it shares the Edwardian's good looks, the design allows increased roof height, even if the building it's connected to is smaller than your average house.

Every conservatory is made to order - contact us today to find out how we can help you.

# Victorian

An elaborate and ornate design, the Victorian conservatory can add glamour to even the most modest of homes.

The hexagonal shape of the Victorian makes it perfect for catching the most amount of sun, offering the best shape for those who want to make the most of the outdoors all year round.

Our Victorian conservatories are available with either a standard or double-hipped roof, allowing for no restrictions to the height of the building it is connected to.



A bay fronted, double-pitched roof with a central ridge, with three segments at the front.



A conservatory with a mono-pitched, variable roof to suit a wide range of properties.



# Traditional

Fun fact: a Traditional, or Lean-to, conservatory is otherwise known as a Sun Lounge conservatory, and for good reason!

A Traditional conservatory is thoroughly practical as it makes the most of the available space, making it one of our most popular styles.

The Lean-to conservatory style is very popular for cottages and bungalows. It is a highly functional, no-nonsense design, providing an attractive extra room for your home.

# Gullwing

The Gullwing is a modern twist on the Victorian conservatory – all the extravagant Gothic influence, with a more flexible shape.

The footprint of the Gullwing conservatory is hexagonal, like the Victorian, but with one long side against the property, allowing the other five sides to give subtle angles to the conservatory shape.

The result is an elegant and indulgent conservatory, perfect for entertaining.



A hexagonal footprint with refined angles gives this design a unique charm.



Gable End roofs are a variant of the Edwardian style and consist of duo-pitched sides with a flat faced frontage.

# Gable End

The Gable End, also known as the 'Pavilion' style, gives your property a more sophisticated garden room style conservatory.

Gable End conservatories are similar in style to the ever popular Edwardian conservatory, but with a flush front, offering a rather sleek and stylish conservatory design. There is also the option to add sunburst detailing on the top glass panels where the sloping roof panel is on its Edwardian counterpart.

A Gable End conservatory is the perfect unobtrusive design that blends in with a modern family home, with the additional roof detailing adding that extra personal touch.

# Orangery

If you are one of the many people looking to add an orangery to your home, our Capella system could be your answer!

Flexibly designed to suit dwarf walls, or a combination of full height brick with bifold or sliding patio doors, you can achieve numerous finishes, and it can be used in combination with a variety of conservatory styles.

The Capella system replicates the 'look' of an orangery through the use of an aluminium high fronted gutter to hide the roof bars, and an internal soffit.

The internal soffit is an eaves beam extension bracket, bringing the eaves beam inwards. This can either be left as plain boards, or it can be used to install speakers or downlights, adding that extra bit of wow factor.

The Capella system can be added onto Edwardian or Gable End style conservatories – ask us today.



An orangery is spacious and stylish all year round, and, thanks to our glazing options, can be enjoyed all year round too.



# Bespoke

Do you require your own bespoke conservatory? We will work with you to make sure you have the conservatory of your dreams!

After your initial phone consultation, our design team will produce drawings and exact measurements so that you can see what will be produced for you in our factory. If you are not happy with any detail, we will work with you until you are.

For more information and a no obligation consultation, call us on 0116 2960728. Our sales consultants have seen it all, so rest assured, no job is too big or too small!



Available in many shapes and sizes to suit your home – please don't hesitate to get in touch.

## Box Gutter

Our box gutter system is a sealed unit that works in tandem with our hipped roofs.

The strong aluminium fabrication is suitable for the necessary support of any kind of roof. Our full instructions make fitting a box gutter very simple – these have solved many design issues when fixing to bungalows or where a side is omitted in a conservatory.

Ask us for more details.

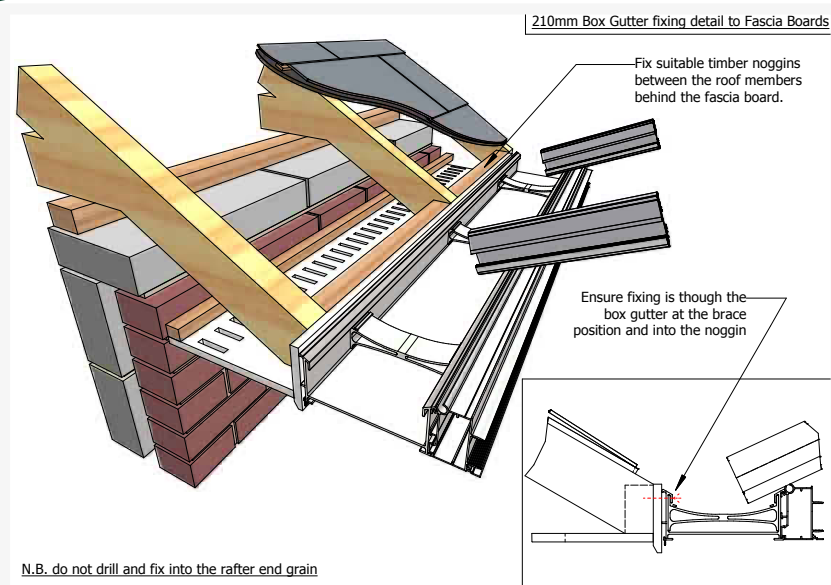

Don't forget – you can have a bespoke design made to suit you and your home! Contact us today for more information and a no obligation consultation – call us on 0116 2960728. Our skilled team will be more than happy to help.



# The Building Process

## 5 easy steps to achieving your perfect conservatory

Why we use Konnect

pg 10

Measuring up for your conservatory

pg 11

Choose your style of conservatory

pg 4-8

Do you need a base? Build your own traditional base or use a Durabase

pg 12

Making your conservatory your own

Panel Styles

pg 13

Glazing Options

pg 14

Celsius Roof

pg 15

Choice of Decorative Glazing

pg 16

Bifolding & Patio Doors

pg 17

Your Choice of Frame Colours

pg 17



# Konnect Technology

Do you have the ideas but are concerned about the skills required to build a conservatory? With Konnect Technology your dreams just came one step closer, so worry no more! Konnect Technology is the system that uses innovation and design to simplify the build process and speed it up considerably.

Our Konnect locking system allows you to lock pre-glazed frames together. Currently, most systems on the market are supplied unglazed, and you screw the frames together, fit the roof and then glaze the windows and doors – a difficult and time consuming process. Our system allows you to lay out the sills and slide the panels together. You simply then take a Konnect cam, slot it into place and, with a ¼ turn, lock it securely.

Worried about joining the conservatory to the house? Our first fix locking system is the answer. No more shifting heavy double doors as our system is supplied in only three parts: the outer frame and two sashes to lift and hinge on. For that extra precision, we make them adjustable in three directions.

A quick check to ensure that the frame sizes are correct and erected, and it's onwards and upwards! Our roofs are made exactly to size to fit on top of the frames. No more cutting down tough polycarbonate sheets. We make everything to fit your sizes.

Still concerned whether you can complete your own installation? We also give you access to our technical assistance freephone number, a step-by-step DVD and a 70-page installation guide to ensure that you get the support you need to complete the job in no time!



1 Sills are pre-routed and cut to size.



2 Panels ready for assembly with factory sill support blocks.



3 Panels engage into sill and slide into position.



4 Aluminium connectors slide down between panels holding them together.



5 Rotating the 1/4 turn button with an Allen key secures the panels and ensures they are the correct distance apart.



6 Once locked into position the buttons are used to locate the cover strip.

- minimal screws**  
fewer parts for more speed
- minimal drilling**  
to keep it clean and tidy
- easy turn buttons**  
to lock panels together
- sill support blocks**  
that lock panels in place
- quicker to install**  
just click, slide and lock

# Your guide to a basic DIY site survey

While it's important to remember that a DIY site survey for your planned conservatory can never, and should never, replace a full professional survey prior to build, going through a few simple steps can help you in choosing the right conservatory specification, getting more accurate quotes prior, and avoiding some of the pitfalls that can be discovered during DIY builds. Here's a quick guide to some simple steps you can go through.

## Get the right equipment

Ensure you have the basic equipment for checking the site and recording the details. You may need: clipboard with A4 graph paper; camera; spirit level; string line and plumb bob; ladder; tape measure.

**Note:** Try to measure in millimetres (mm), not inches or feet.

## Check for needed planning permission / building regulations

Make yourself aware of national and local laws covering planning permission and building regulations to ensure you know any restrictions that may be imposed upon your planned conservatory design. A good place to start is online at [www.planningportal.gov.uk/permission/commonprojects/conservatories/](http://www.planningportal.gov.uk/permission/commonprojects/conservatories/)

## Create a rough layout on site

Use sticks, or anything else suitable, laid out on site to create the rough size and position of the conservatory you are planning, to be sure the size and shape are suitable for you. Use this as an opportunity to consider the best door position and for what effect the position of doors, steps, etc., may have on your plans. By positioning the doors on the front facet, you are creating a corridor effect from the house doors to the conservatory doors. Realistically, no furniture can be placed in this 'corridor', and the usable area within the conservatory is effectively reduced.

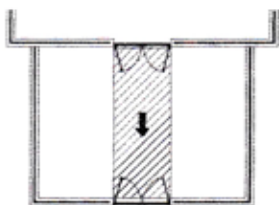

Route to garden requires passage through ideal location for furniture.

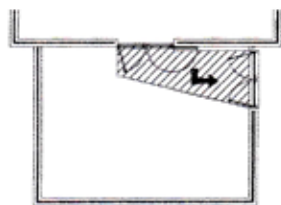

This would be the shortest route to the garden, allowing better use of more space.

The position of external steps, if needed, will also affect your design. Be aware of whether you are laying out internal or external size (i.e. allowing for wall/frame thickness).

## Check for height restrictions

Measure the maximum ridge height (where the very top external edge of your conservatory will meet the house) to be sure there are no restrictions (upper windows, etc.). If you are fitting a conservatory to an existing bungalow soffit, you will need to know the depth of soffit, height of fascia board, and height to underside of soffit from damp proof course, so that your conservatory can be designed to suit them (seek advice from your supplier).

## Check the ground condition

Be aware of any slopes or drop downs that would need to be accommodated.

## Check the ground and house wall for obstructions

Check for anything that may affect the conservatory or base, such as manholes, soil pipes, downpipes, taps, boiler expansion pipes, air bricks, cables, outside lights etc. Determine what can be relocated, and what must be designed around.

## Determine foundation or base requirements

You may be installing onto an existing foundation, a patio, a lawn or other surface. This will affect your choice of base building method. Research the different types of base construction open to you to determine what is best suited to your situation.

## Check internal floor height

Check internal floor height as it relates to the external line of your damp proof course; this may affect base and step requirements.

## Check house wall for plumb

Use a plumb line fixed at ridge height to determine the overhang of your house wall. You can adjust your conservatory size accordingly, and ensure you obtain sufficient material to pack the gap created if your house is not at 90 degrees to the base. This may affect your requirements for cavity trays or flashing.

## Check access

Ensure you have suitable access to the site for delivery of materials, a skip for waste, etc.

## Measure, measure, measure

Double check that all measurements for your final specification are correct, now that you've made the appropriate allowances.

# Durabase

The Durabase system is a proven solution for conservatory bases – no mess, no hassle and it only takes a fraction of the time to install. And those are just a few of the benefits!

The Durabase system comprises a bespoke steel base and modular wall, made to exact specifications, ensuring a perfect fit for your conservatory every time.

1



**Choose the site** for your conservatory. Durabase can be sited anywhere, even on a sloping site.

2



**Install the concrete** pads as per the plan supplied. Note the lack of mess and disruption!

3



**Lay down the steel** base and level using the adjustable legs, then fix to the house wall.

4



**Attach the brick skirt** and modular wall to the steel base and finish by putting the bridging tiles in place.

## The Benefits

**Quicker** - The Durabase arrives in kit form, complete with flooring and underfloor insulation ready for a quick and easy assembly. The average base can be installed in a day!

**Easier** - Uneven or sloping sites and difficult site access are easily overcome with Durabase.

**Cleaner** - There's no need for large scale excavations, which minimises the amount of soil to dispose of and disruption caused to the site.

**Cost effective** - No need for expensive relocating of manholes or drains.

**Straightforward installation** - Durabase is suitable for professionals, or can be assembled with just a little DIY experience. No tradesmen required – the modular walls are bricked and mortared before they are delivered to site.

**U-Value** - The following U-Values can now be achieved:  
Walls - 0.19W/m<sup>2</sup>k.  
Floors - 0.18W/m<sup>2</sup>k

# Panel Styles

We know how important it is to create a truly individual effect for your conservatory. The kind of panel you choose can have an enormous influence, so we deliberately give you as much of a free hand as possible.

Our conservatory ranges are available in 3 choices of panels: Dwarf Wall, Infill Panel and Glass to Ground (also known as Full Height). Panels are then available in different options to accommodate the needs of your design, be it a simple glass frame, a transom (where the glass is divided by a solid bar), a top opening window, or a large top-hung opening window.

Whatever your preference, each item is made to the same exacting quality and security standards.

## Dwarf Wall

Dwarf Wall is when the lower part of your conservatory is a solid brick wall (or Durabase panels), with the conservatory frame installed on top.



## Infill Panel

Infill panel is when the conservatory frame runs from ground to roof, but the lower part is filled in with a PVCu panel, rather than glass.

## Glass to Ground

Glass to Ground panels are when the conservatory frame runs from ground to roof, with the frame entirely filled with glass.



## Door Styles

Doors & French doors are available in Infill and Glass to Ground styles. Patio and bifold doors are also available.

# Glazing Options

## Roof Polycarbonate

Our conservatory roofs can be supplied with either 25mm or 35mm polycarbonate.

Polycarbonate is available in Clear, Opal, Bronze, Bronze/Opal or Heatshield varieties, and are all finished in a special coating protecting the surface from wear and discolouration.

Heatshield polycarbonate reduces the build-up of heat in the summer, whilst retaining internal heat in the colder months.

### Heatshield



### Opal



### Bronze/Opal

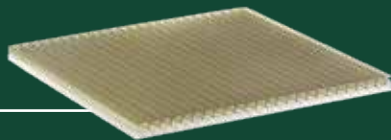

### Clear

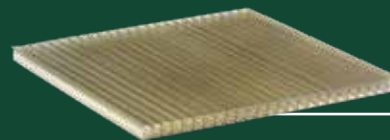

### Bronze

## Bio Clean

If you prefer a glass roof for your conservatory, we can supply 24mm Bio Clean self-cleaning glass. Here's how it works:

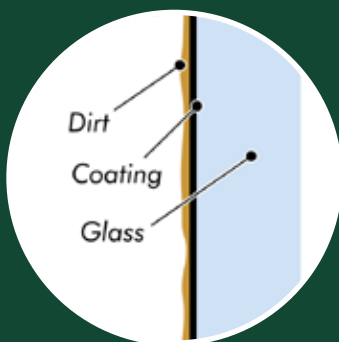

### Coating activated by UV Light

After installation, the special coating needs 5-7 days of exposure to daylight to activate fully.

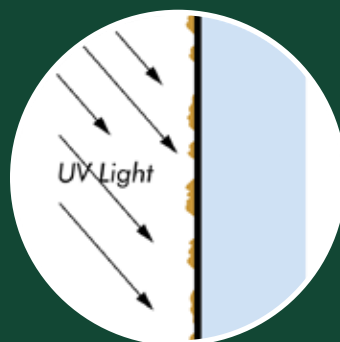

### Organic dirt is broken down

The coating breaks down organic dirt and, by doing so, reduces the adherence of inorganic dirt.

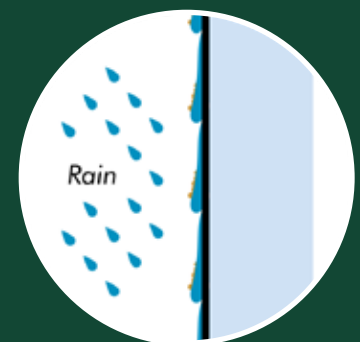

### Rain washes dirt away

Water droplets spread out to form a sheet. Dirt particles on the surface are picked up by the water and washed off the glass.

# KEEP YOUR CONSERVATORY



# WITH A CELSIUS GLASS ROOF



**CELSIUS One™**  
PERFORMANCE GLASS

With its blue tint and enhanced abilities, Celsius One sets a new standard in performance glazing.



Heat Reflection  
**78%**



U-Value  
**1.0**



UV Protection  
**94%**

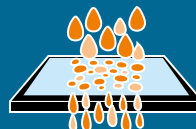

Easy  
Clean

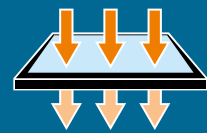

Visible Light  
Transmission  
**38%**

## UPGRADE TO CELSIUS ONE ROOF TODAY

# Your Choice of Decorative Glazing

Add a touch of individuality and glamour to your conservatory with our range of decorative glass options. Known as top light glazing, these panels can be used above a transom bar as a fixed panel, or in a top opening window.



## Leaded Top-Lights with **Bevel**



Style 8



Style 9



Style 10



Style 19

## Leaded Top-Lights with **Colour**



Style 6



Style 7



Style 5

## Leaded Top-Lights



Style 4



Style L



# Bifolding & Patio Doors

We can provide you with a range of PVCu bifolding and sliding patio door solutions, allowing you to fully open up your space and take advantage of your new-found connection to your outside space.

Bifolding doors are a popular choice with customers. One of the biggest advantages is that the doors, when open, allow up to 90% of a clear opening – this really is 'letting the outside in'!

Sliding inline patio doors let the opening door slide behind a fixed panel. The doors can be handed left or right to maximise accessibility to the garden.

Both options are double glazed as standard, and an option to upgrade to Low-E Argon-filled double glazed units is also available.



## Your Choice of Frame Colours

The standard range of colours available to choose from for your conservatory are White, Rosewood and Golden Oak. These three are available for the interior as well as the exterior of a conservatory. Combination options of a Rosewood/Golden Oak exterior and a White interior are also available.

We also offer colours with a woodgrain effect – White, Irish Oak, Anthracite Grey, Black/Brown, Chartwell Green and Cream. The woodgrain colours are available on the exterior with a white interior.

Our woodgrain effect is so realistic, it is almost impossible to tell the difference! And without the maintenance requirements of painting or rot proofing, it makes for a perfect choice for your conservatory.



Rosewood



Golden Oak

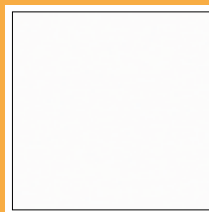

White



Irish Oak



Cream

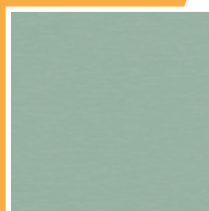

Chartwell Green

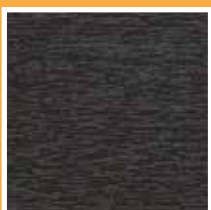

Black/Brown

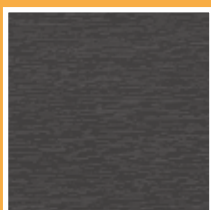

Anthracite Grey

# Stratus Lantern Roof

The purpose designed Stratus aluminium lantern roof system is discreet yet stylish. Stratus allows light to flood into your home's interior, the ideal modern lantern solution, coupling sleek contemporary looks with truly outstanding performance.

Designed from the ground up around an innovative thermally broken system, it provides excellent thermal performance – keeping cool in the summer and warm in the winter – while delivering the architectural refinement you'd expect of a high end aluminium lantern system.

Whether you are building a new kitchen-diner extension or replacing an existing lantern roof, Stratus will help redefine your home, creating light and airy spaces for you to enjoy.

Contact us today for more information.

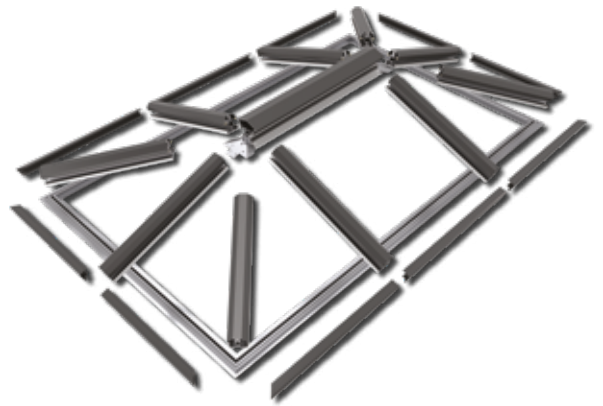

More thermally efficient.  
Warm in winter and cool in summer

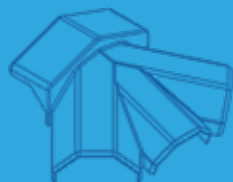

Hard wearing aluminium exterior for a premium finish

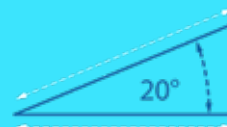

20° pitch and discreet cappings for a clean, modern look



Choose from 3 design styles and white/grey colour options

# WarmCore Bifold Doors



Built around a belief that beauty doesn't have to compromise performance, WarmCore aluminium folding sliding doors were created out of a desire to combine the desirability and durability of aluminium with unparalleled insulation. The orange thermal core – hidden away in the finished doors – is key to why WarmCore doors are 25% more thermally efficient than traditional aluminium systems.

Strong and secure, WarmCore doors come with class leading security built in. Inwards or outwards opening doors up to 6m wide, with as many as 7 opening sashes glide along custom designed tracks, while a wealth of colour, style and configuration options help you choose the perfect warm, secure and beautiful WarmCore door for your home.

WarmCore bifold doors are a fantastic choice for any conservatory. Contact us to find out more.



# WarmCore Patio Doors

WarmCore inline patio doors allow natural light to flood in to your home through large glazed sashes that maximise the enjoyment of your view. The full width thermal core at the heart of the WarmCore range lets you enjoy the desirability and durability of aluminium, while keeping your home snug and warm. Custom designed 10-wheel rollers glide effortlessly on a precision engineered track, making these panoramic doors the perfect blend of aesthetics and performance.

Each WarmCore patio door is designed to provide maximum security performance whilst also remaining sleek and stylish, with an emphasis on clean, modern aesthetics from the frame to the hardware and everything in between.

The WarmCore patio door is available with 2, 3 and 4-pane configurations, meaning you can choose a style that suits both your home and living style.

To find out more, please call us on 0116 2960728.



# WarmCore Windows

WarmCore windows help modernise the look of any home, combining the warmth of PVCu with the aesthetics and desirability of aluminium in casement, flush, and tilt & turn styles.

WarmCore windows offer up to 75% better thermal performance than standard aluminium, and are even available in a Slim Vent option, offering 17% slimmer sightlines at the same cost as a standard frame. Dual colour is also available as standard on all styles, for the finishing touch.

You will truly benefit from a WarmCore window. Contact us today to find out more.



# Celsius Solid Roofs

The Celsius Solid Roof is an innovative tiled roof system for conservatory retrofits, as well as new conservatory style extensions. Celsius Solid Roof is constructed using highly insulated SIPs (Structural Insulated Panels), deliberately avoiding the use of an aluminium framework to create a truly warm solid roof construction with no possibility of cold bridging.

Celsius Solid Roofs are bespoke, manufactured to precisely meet project requirements, and come supplied in kit form for convenient and speedy assembly on site. Designed to be fast to fit, the Celsius Solid Roof can be weathertight in a few hours, and using a patented and environmentally-friendly tile system that does not require battening, installations can be finished quickly, with the minimum of disruption for the homeowner.

The Celsius Solid Roof is available in 4 styles – Lean-to, Gable, Georgian and Victorian. Contact us today for more information on this revolutionary system.



## Fixed Roof Light

The WarmCore Fixed Roof Light has been designed exclusively for the Celsius Solid Roof to offer improved looks and exceptional thermal performance.

Utilising a stepped glass structure and subtle ceramic edge, the roof light has an incredibly clean-looking finish and adds up to 41% more visible light than alternative roof lights. Finished with a discreet black flashing kit, it looks great both inside and out.



Crisp White



Anthracite Grey

# Any Questions?

## What is your guarantee?

All of our conservatories carry a 10-year guarantee. Full warranty information can be found on the reverse of your order confirmation.

## What does the price include?

VAT and delivery to the UK mainland and all conservatory components. It doesn't include basework, bricks, installation and lead flashing. Prices for bases to suit can be quoted for by calling us on 0116 2960728.

## Do you deliver overseas?

Yes we do! We can deliver to off shore UK islands and the Republic of Ireland. For other countries, just tell us your port of choice and we'll make sure it gets there.

## Can I change the design after I've placed the deposit?

Anything can be changed up until the point you sign and confirm the final specification.

## How long does it take for delivery?

It takes about 4-6 weeks from the date we receive your signed drawings. Delivery may be delayed if necessary.

## What PVC do you use?

We use Grade 1 virgin material, no regrind, therefore, we can guarantee against PVC discolouration.

## Do you conform to British Standards?

Yes. All of our components meet at least the minimum requirements for British Standards, and our Durabases are JHAI approved.

## How is delivery arranged?

You will be informed of your delivery date during the design and purchasing process. Our logistics partner will contact you on the day of delivery, approximately 1hr before they are due to arrive. Two drivers are sent and therefore no assistance is required for offloading; however, someone does need to be at the property to sign for the conservatory.

## Do I need planning permission?

As planning permissions vary, it is wise to check with your local authority to go over the planning and building requirements applying to your property, especially where listed buildings or conservation areas may be concerned.

## How will I know the conservatory will fit?

Once you have placed your deposit, you will receive a full set of plans. These plans need to be checked against your site. At this stage, any detail can be changed. However, if you are happy with the dimensions, sign and return your plans; your conservatory will then be manufactured.

## How easy are the conservatories to build?

Our conservatories are designed for the DIY market using a simple connect system. All structures are pre-drilled and a full installation manual is provided. If you need any assistance, we have a fitting helpline and we can talk you through each stage.

## Do you do made-to-measure sizes?

Yes, we make all of our conservatories to suit each individual's needs.

## Are you Fensa registered?

No. Fensa is an installers certificate, for windows and doors only.

## Do you fit the conservatories?

No, we predominantly supply our easy to fit conservatories to trade and DIY customers. We can arrange fitting with one of our third party fitting teams – call 0116 2960728 for a fitting quote.

## Do you manufacture windows and doors?

We specialise in conservatories, although we can supply French or sliding doors for the house when you place your conservatory order.

## How do I pay?

We accept all major credit and debit cards, personal and building society cheques, bank transfers and PayPal.

## Do you do timber conservatories?

No. We offer a high quality woodgrain effect in either traditional Golden Oak or Rosewood.

## What does PVCu stand for?

Unplasticised Poly Vinyl Chloride.





Unit L Linwood Workshops  
Linwood Lane  
Leicester LE2 6RL  
0116 2960728

[www.diyconservatoryquotes.co.uk](http://www.diyconservatoryquotes.co.uk)  
[www.conservatorybasecompany.co.uk](http://www.conservatorybasecompany.co.uk)